

**Series 4, heat pump tumble dryer, 8 kg  
WTH85V10GC**



- **ComfortDisplay:** easy orientation and usability thanks to a big display.
- Anti-Vibration Side Panels reduce vibrations and ensure greater stability during the washing and spinning process.

---

**Technical Data**

Built-in / Free-standing : Free-standing  
Removable top : No  
Door hinge : Right  
Color / Material body : White  
Length electrical supply cord : 145.0 cm  
Height with worktop : 0 mm  
Net weight : 48.3 kg  
Drum volume : 112 l  
Fluorinated greenhouse gases : No  
Type of refrigerant : R290  
Hermetically sealed equipment : Yes  
Connection Rating : 625 W  
Voltage : 220-240 V  
Drying process : automatic  
Capacity cotton - NEW (2010/30/EC) : 8.0 kg  
Energy efficiency rating : A++  
Energy consumption electric dryer, full load - NEW (2010/30/EC) : 1.87 kWh  
Standard cotton programme time at full load : 205 min  
Energy consumption electric dryer, partial load - NEW (2010/30/EC) : 1.14 kWh  
Standard cotton programme time at partial load : 130 min  
Weighted annual energy consumption, electric dryer - NEW (2010/30/EC) : 236.0 kWh/annum  
Power consumption in off-mode - NEW (2010/30/EC) : 0.10 W  
Power consumption in left-on mode - NEW (2010/30/EC) : 0.75 W  
Weighted programme time : 162 min  
Average condensation efficiency full load (%) : 81 %  
Average condensation efficiency partial load (%) : 81 %  
Weighted condensation efficiency (%) : 81 %

---



4 242005 266401

## Series 4, heat pump tumble dryer, 8 kg WTH85V10GC

- Stainless steel front

### Main features

- Capacity: 8 kg
- Dryer type: Condenser
- Energy efficiency class: A++
- Energy consumption 236.0 kWh per year, based on 160 drying cycles of the standard cotton programme at full and partial load, and the consumption of the low-power modes. Actual energy consumption per cycle will depend on how the appliance is used
- Energy consumption of the standard cotton programme at full load 1.87 kWh and energy consumption of the standard cotton programme at half load 1.14 kWh
- power consumption in off-mode 0.1 W and in left-on mode 0.75 W
- The programme Cotton cupboard dry used at full and partial load is the standard drying programme to which the information in the label and the fiche relates, this programme is suitable for drying normal wet cotton laundry and is the most efficient programme in terms of energy consumption for cotton.
- Weighted programme time of the standard cotton programme at full and partial load: 162 min.
- Programme time of the standard cotton programme at full load 205 min and programme time of the standard cotton programme at partial load 130 min.
- Condensation efficiency class B on a scale from G (least efficient) to A (most efficient).
- standard cotton programme at full load 81 % and average condensation efficiency of the standard cotton programme at partial load 81 %.
- Weighted condensation efficiency for the standard cotton programme at full and partial load: 81 %.
- Noise level: 65 dB (A) re 1 pW

### Programmes

- Special programmes: woollen finish, mix, towels, Time program warm, Time program cold, sportswear, Down wear, Super 40, shirts/blouses

### Options

- Anti crease cycle 60 min at the end of the programme
- Touch control buttons: Low Heat, less ironing, programme length, Fine-tuning of drying aim, 24 h Ready in

### Convenience and Safety

- Protection filter for condensor
- DUO-Tronic
- Fully electronic control dial for sensor drying programmes, timed and special programmes
- LED-Display for remaining time and 24 h end time delay, programme status indication, special functions
- Active flow drying system: Big Stainless steel with textile care structure, soft design paddles
- AntiVibration Design: More stable and silent
- Wool Drying Basket
- Drain set for condensate
- Drum interior light
- Childproof door lock
- Buzzer to indicate the end of cycle
- pull-open latch
- Door hinge: right-hand
- Metal door closing hook

### Technical information

- Can be built-under
- Dimensions (H x W x D): 84.2 x 59.8 x 61.3 cm
- Dimensions (H x W): 84.2 cm x 59.8 cm
- Appliance depth: 61.3 cm
- Appliance depth incl. door: 66.5 cm
- Appliance depth with open door: 110.5 cm

## Series 4, heat pump tumble dryer, 8 kg WTH85V10GC

Measurements in mm

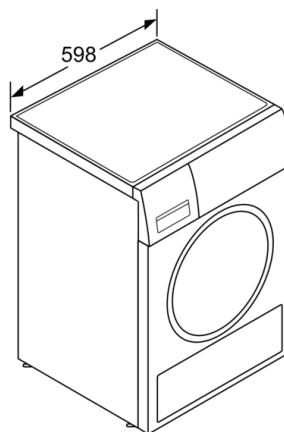
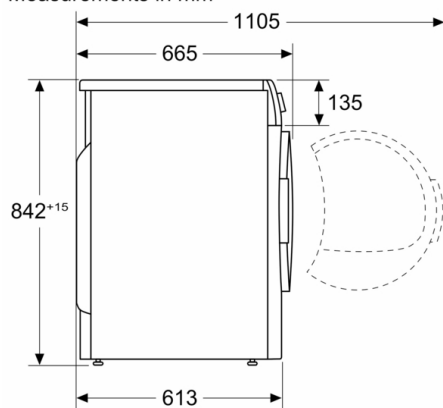

measurements in mm