

**Series 4, washing machine, front loader, 9 kg, 1200 rpm  
WGA142X0GC**



**Stain expert washing machine with innovative Presoaking and AntiStain system: Automatic removal of stubborn stains even for delicate textiles.**

- **AntiStain:** detects and removes the 4 most common stains.
- **Pre-Soaking** option conveniently helps you remove stubborn and ground-in stains from fabrics by giving you flexible and automatic soaking phase.
- **AllergyPlus:** specially developed for the needs of allergy sufferers and sensitive skin.
- **SpeedPerfect:** perfectly clean in up to 65% less time.
- **WaveDrum:** especially gentle and efficient washing thanks to a unique drum structure.

**Technical Data**

Built-in / Free-standing : Free-standing  
 Door hinge : Left  
 Color / Material body : White  
 Length electrical supply cord : 160 cm  
 Height for building under : 845.00 mm  
 Height of the product : 845 mm  
 Dimensions of the product : 845 x 597 x 588 mm  
 Wheels : No  
 Net weight : 67.6 kg  
 Drum volume : 63 l  
 Main colour of product : White  
 Door Frame : Silver-inox, black-grey  
 Color Dial : Chrome-black  
 Noise level washing : 51 dB(A) re 1 pW  
 Connection Rating : 2300 W  
 Fuse protection : 10 A  
 Voltage : 220-240 V  
 Frequency : 50 Hz  
 Energy Star Qualified : Yes  
 Cord Included : No  
 Plug type : GB plug  
 Length of supply hose (in) : 59.05  
 Dimensions of the packed product : 34.64 x 25.31 x 26.77  
 Net weight : 149.000 lbs  
 Gross weight : 151.000 lbs  
 Length of drain hose : 150.00 cm  
 Length of supply hose : 150.00 cm  
 Dimensions of the packed product (HxWxD) : 880 x 680 x 643 mm  
 Gross weight : 68.6 kg  
 Connection Rating : 2300 W  
 Fuse protection : 10 A  
 Voltage : 220-240 V  
 Frequency : 50 Hz  
 Water protection system : Multiple water protection  
 Number of Options : 8  
 Maximum spin speed : 1200 rpm  
 Spin speed options : Variable  
 Digital countdown indicator : Yes  
 Drying progress indicator : LED, LED-display



**Series 4, washing machine, front loader, 9 kg, 1200 rpm  
WGA142X0GC**

**Stain expert washing machine with innovative Presoaking and AntiStain system: Automatic removal of stubborn stains even for delicate textiles.**

**Main features**

- Capacity: 9 kg
- Energy Efficiency Class: 3 Energy Stars
- spin-drying efficiency class: B
- Max. spin speed: 1200 rpm
- Cottons 60 Eco and Cottons 40 Eco are the standard washing programmes to which the information in the label relates. These programmes are suitable to clean normally soiled cotton laundry and are the most efficient programmes in terms of combined energy and water consumption.
- Noise level washing dB (A) re 1 pW: 51
- Noise level spinning dB (A) re 1 pW: 74
- 3 Energy Stars according to the UAE energy efficiency label with energy consumption of 257 kWh per year and water consumption of 14170 l per year

**Programmes**

**Options**

- PreSoaking: Works against stubborn stains.
- AntiStain: Automatic removal of the most common stains.
- varioPerfect: time or energy optimized programs with perfect wash performance
- Touch control buttons: Start / Reload / Pause, Reduced Ironing, SpeedPerfect, Spin speed reduction/Yes

**Convenience and Safety**

- Reload function: Be flexible in adding laundry items even after start of the wash cycle.
- WaveDrum
- Multiple water protection
- Large display for temperature, spin speed, remaining time, 24 h end time delay and load recommendation
- Fully electronic control dial for all wash- and special programs
- AntiVibration Design: more stability and quietness
- 3D AquaSpa wash system with cascade for faster water penetration
- infinitely variable
- loading introduction
- Foam detection system
- Unbalanced load detection
- Self cleaning detergent drawer
- AquaSensor for optimum rinse results: Yes
- Childproof door lock
- Buzzer
- Metal door closing hook
- Magnet Lock

**Technical information**

- Dimensions (H x W x D): 84.5 x 59.7 x 58.8 cm
- Can be built-under

**Series 4, washing machine, front loader, 9  
kg, 1200 rpm  
WGA142X0GC**

measurements in mm

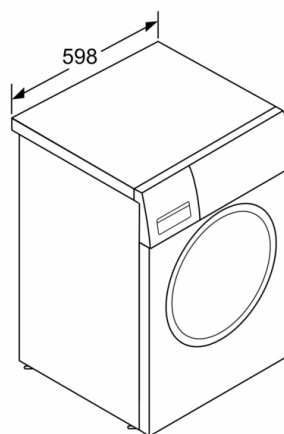
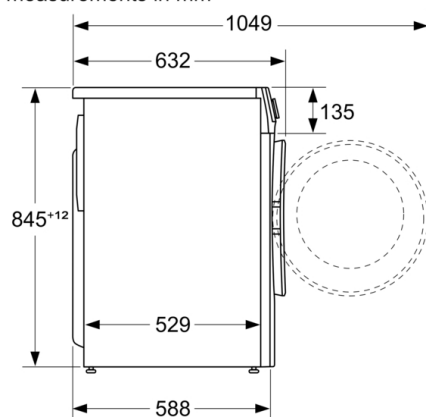

measurements in mm