

**Serie | 6, washing machine, front loader, 9 kg, 1400 rpm
WAT28S80GC**



The washing machine with EcoSilence Drive™: enjoy supremely quiet operation and excellent durability.

- **EcoSilence Drive™:** extremely energy-efficient and quiet in operation with a 10-year warranty.
- **SpeedPerfect:** perfectly clean in up to 65% less time.
- **WaveDrum:** especially gentle and efficient washing thanks to a unique drum structure.
- **ActiveWater™Plus:** reduced water consumption and costs thanks to a sensor-controlled, stepless automatic load adjustment system.
- **Reload function:** allows you to add any forgotten item comfortably while washing.

Technical Data

| | |
|-------------------------------------------------|---------------------------|
| Built-in / Free-standing : | Free-standing |
| Door hinge : | Left |
| Color / Material body : | White |
| Length electrical supply cord (cm) : | 160 |
| : | 848.00 |
| Height of the product (mm) : | 848 |
| Dimensions of the product (mm) : | 848 x 598 x 590 |
| Wheels : | No |
| Net weight (kg) : | 71.139 |
| Drum volume (l) : | 60 |
| Main colour of product : | White |
| Door Frame : | chrome, white |
| Noise level washing (dB(A) re 1 pW) : | 49 |
| Connection Rating (W) : | 2300 |
| Current (A) : | 10 |
| Voltage (V) : | 220-240 |
| Frequency (Hz) : | 50 |
| Energy Star Qualified : | Yes |
| Cord Included : | No |
| Plug type : | GB plug |
| Length of drain hose (in) : | 59.05 |
| Length of supply hose (in) : | 59.05 |
| Appliance Dimensions (h x w x d) (inches) : | x x |
| Dimensions of the packed product (in) : | 34.05 x 24.80 x 26.77 |
| Net weight (lbs) : | 157.000 |
| Gross weight (lbs) : | 159.000 |
| Length of drain hose : | 150.00 |
| Length of supply hose : | 150.00 |
| Dimensions of the packed product (HxWxD) (mm) : | 865 x 680 x 630 |
| Gross weight (kg) : | 72.1 |
| Connection Rating (W) : | 2300 |
| Current (A) : | 10 |
| Voltage (V) : | 220-240 |
| Frequency (Hz) : | 50 |
| Approval certificates : | CE, G-Mark, VDE |
| Water protection system : | Multiple water protection |
| Number of Options : | 7 |
| Spin speed options : | Variable |
| Digital countdown indicator : | Yes |
| Drying progress indicator : | LED, LED-display |



Serie | 6, washing machine, front loader, 9 kg, 1400 rpm WAT28S80GC

The washing machine with EcoSilence Drive™: enjoy supremely quiet operation and excellent durability.

- WAT28S80GC

Main features

- Capacity: 9 kg
- Energy Efficiency Class: 3 Energy Stars
- spin-drying efficiency class: B
- Max. spin speed: 1400 rpm
- Cottons 60 Eco and Cottons 40 Eco are the standard washing programmes to which the information in the label relates. These programmes are suitable to clean normally soiled cotton laundry and are the most efficient programmes in terms of combined energy and water consumption.
- Noise level washing dB (A) re 1 pW: 49
- Noise level spinning dB (A) re 1 pW: 75
- 3 Energy Stars according to the UAE energy efficiency label with energy consumption of 212 kWh per year and water consumption of 14404 l per year

Programmes

- Special programmes: Single Rinse, dark laundry, quick wash/ mixture, Spin / Drain, Automatic, AllergyPlus / Hygiene, Super 15 min / Super 30 min, Duvet, wool, delicates/silk

Options

- varioPerfect: time or energy optimized programs with perfect wash performance
- Touch control buttons: Start / Reload / Pause, SpeedPerfect, Spin speed reduction/Yes

Convenience and Safety

- Reload function: Be flexible in adding laundry items even after start of the wash cycle.
- Drum volume: 60 l
- VarioDrum: gentle and efficient washing
- 32 cm porthole, chrome, white with 171° opening door
- Metal door closing hook
- Magnet Lock
- Ferrite-BLDC
- EcoSilence drive with 10 year warranty
- AntiVibration Design: More stable and silent
- Turbidity sensor
- Flow-through sensor
- ActiveWater: water management system
- Multiple water protection
- 3D AquaSpa wash system with cascade for faster water penetration
- infinitely variable
- Consumption Indication: Information about energy consumption
- Fully electronic control dial for wash programmes, temperature and special programmes
- Large LED-Display for programme status indication, temperature selection, max. spin speed, remaining time and 24 h end time delay, load recommendation and consumption indication
- AquaSensor for optimum rinse results: Yes
- Foam detection system
- Unbalanced load detection
- Childproof door lock
- Buzzer to indicate the end of cycle

Technical information

- Can be built-under
- Dimensions (H x W x D): 84.8 x 59.8 x 59 cm
- i-DOS: automatic dosing of liquid detergent and softener

**Serie | 6, washing machine, front loader, 9
kg, 1400 rpm
WAT28S80GC**

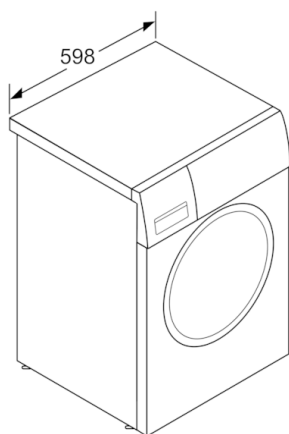

measurements in mm

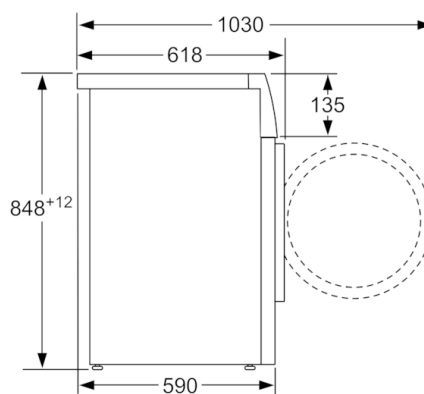

measurements in mm